

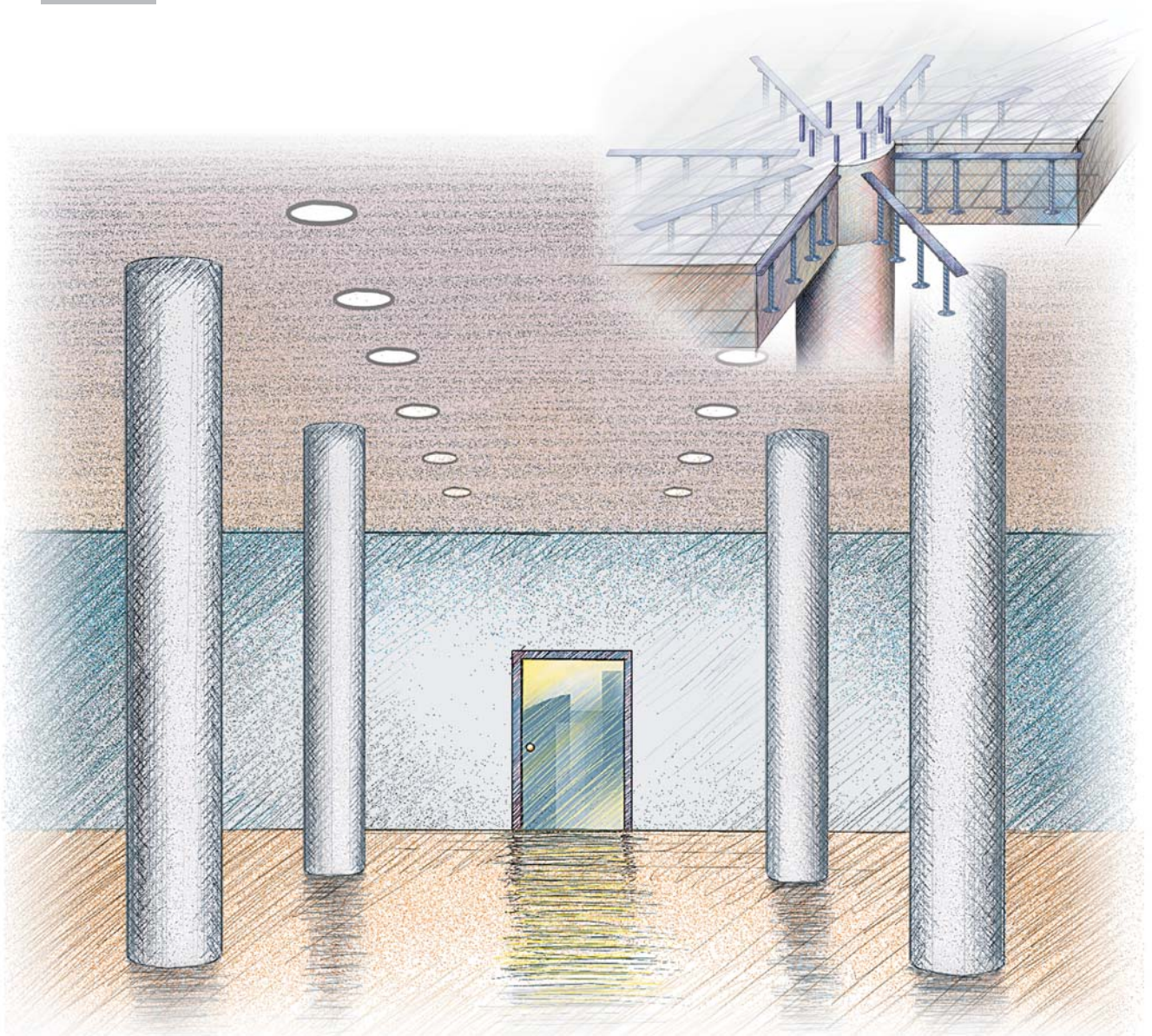

JORDAHL®
FIXING TECHNOLOGY



JORDAHL®-Studrails JDA

Deutsche Kahneisen Gesellschaft mbH Berlin

E-Mail: info@jordahl.de

Internet: www.jordahl.de

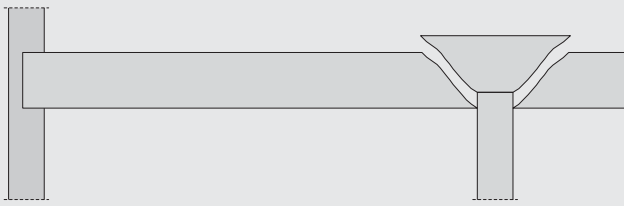

Fig 1: punching failure

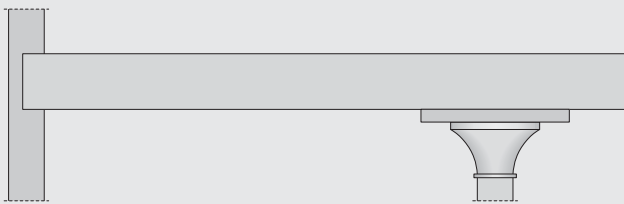

Fig. 2: mushroom floor slab with column capitals

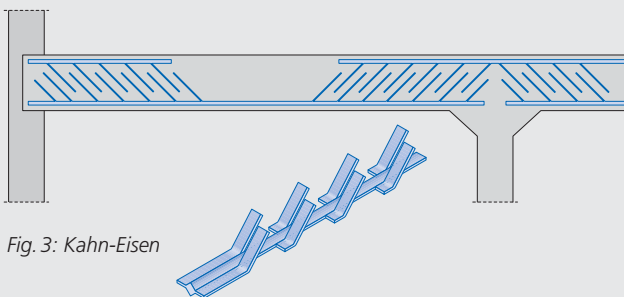

Fig. 3: Kahn-Eisen

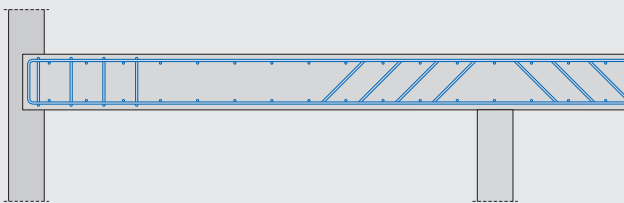

Fig. 4: flat ceiling with bent-up rebar

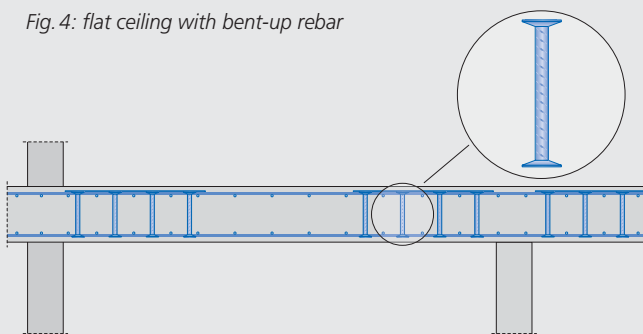

Fig. 5: JDA-punching shear reinforcement

A piece of history

The product name "JORDAHL" invokes memories of a pioneer of fixing technology and the inventor of the cast in channel. Our company name "KAHNEISEN" goes back even further, to the start of reinforced concrete. Kahn steel (Fig. 3) was already in use as reinforcing steel at the beginning of the 20th century. It had upturned wings that resisted transverse forces in the ceiling panel area. The involvement of the Kahn Brothers in the reinforcement of concrete and the optimum utilisation of cross-section and form was the stimulus for us when incorporating studrails into our product range.

Flat roof structures with large spans between supporting columns, allow optimum use of large area factory or warehouse buildings.

Advantages

- underside of ceiling has flat appearance
- less outlay for formwork
- optimum use of space

However, even in the early days of concrete structures, the problem of punching shear at the column head area (Fig. 1) was recognised. An alternative to get around the troublesome downstand was the design of column capitals in about 1900 (Fig. 2).

More recently, plates with stud type supports in accordance with DIN 1045 have been adopted. These can be designed with or without a capital and with saddles or angled wings for thrust reinforcement depending upon the loading conditions. This solution will often result in thick slabs, a limitation of spans between supporting columns and it is time consuming at installation time (Fig. 4).

As an alternative, Andrä et al have proposed doweling the area weakened by the punching shear using dowel strips. This solution was developed further to produce studrails made from reinforcing steel, each with two swaged heads (Fig. 5).

With implementation of german standard DIN 1045-1:2001 a basic revision of the german approval became necessary. The new german approval Z-15.1-214 corresponds with the partial safety factor approach (like in the Eurocodes) and replaced the old approval Z-15.1-172.

Further information

More technical information is available by contacting us at the following address:

Deutsche Kahneisen Gesellschaft mbH
Nobelstrasse 51
D-12057 Berlin, Germany

Fon: +49 - 30/682 83-02, Fax: +49 - 30/682 83-497
E-Mail: info@jordahl.de, Internet: www.jordahl.de

The made-to-measure solution JORDAHL® JDA Studrail

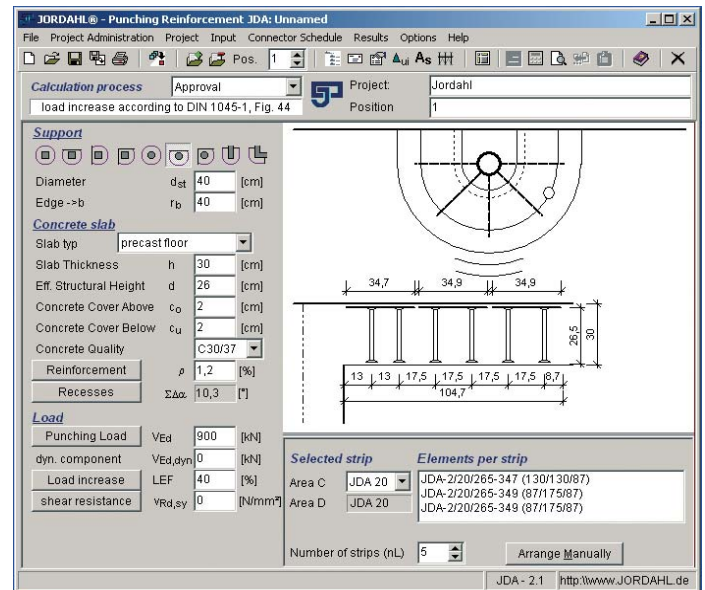

The solution: JDA studrail

Double-headed anchors have achieved the best results in tests. In practice they have shown themselves to be a particularly efficient and economical method of punching shear reinforcement. JORDAHL® JDA studrail consists of double headed anchors connected by a metal strip. Alternative spacing methods are also available to suit specific installations, e.g. with spacing rods for use in precast slabs.

Advantages

- Construction authority approved for static and dynamic loads (to meet the requirements of BS, ACI, DIN, Eurocode and CSA)
- Higher loading with slip resistant transmission of force due to the arrangement of the anchor heads on each side
- Optimum slab thickness, can be achieved for slab thicknesses above 18 cm
- Saves time by fitting from above after laying the whole of the reinforcement cage
- Suitable for precast slabs by fixing on the formwork or by laying on mesh supports

Anchor support capabilities

anchor diameter d_A [mm]	head diameter d_K [mm]	head thickness h_K [mm]	anchor cross section A [mm ²]
10	30	5	79
12	36	6	113
14	42	7	154
16	48	7	201
20	60	9	314
25	75	12	491

The service

JORDAHL® provides custom solutions, made-to-measure:

- To suit your design criteria and specific application requirements
- with skilled technical advice and
- fast and flexible delivery
- calculation software

The product

The JORDAHL® studrail is manufactured to the appropriate static requirements.

The double headed anchors can be supplied with $d_A = 10, 12, 14, 16, 20$ and 25 mm. The length of the anchor is between 125 and 650 mm.

Longer lengths can be manufactured at the customer's request.

Double-headed anchors are made from BSt 500 S and the connecting strip is made from structural steel.

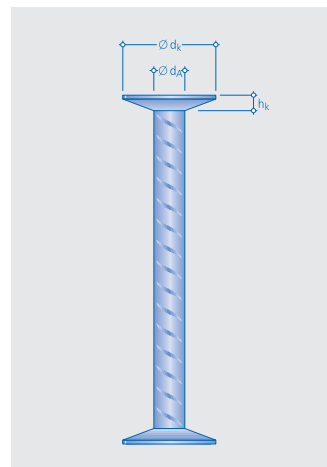

JORDAHL®-JDA Studrail

Applications / Installation

Range of applications

Depending on the architectural or design criteria, studrails can be adapted for use at slab edges, in corners and piers.

Examples 1 to 9 below indicate a typical range of applications for JORDAHL® studrails.

Example 1

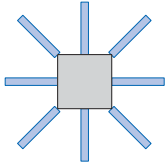

Rectangular internal support

Example 2 + 3

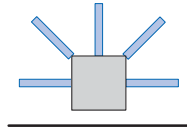

Rectangular edge support

Example 4

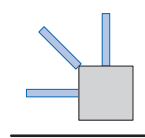

Rectangular corner support

Example 5

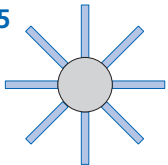

Round internal support

Example 6 + 7

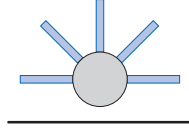

Round edge support

Example 8

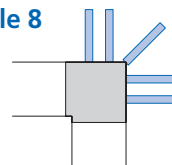

Internal corner

Example 9

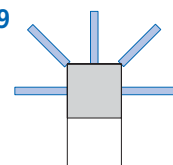

End of wall

Additional application solutions

When used in suspended installations, the free anchor heads must extend at least to the lower edge of the bottom layer of reinforcement and, in upright installations, to the upper edge of the top layer of reinforcement.

At the same time, the required concrete cover must be maintained.

Installation from above

This is the most common way: first install all the rebar, then push the studrails through the mesh.

Installation from below using JDA-FT-KL

JDA studrail is fitted on the formwork using connecting strips on suitable spacers. This version is installed in three steps:

- position the metal strips with spacers on the formwork
- install all rebar and lattice girders
- click the anchors into the metal strip



Installation of JDA-FT-KL (the click version)



Installation from above for in situ concrete



Installation underneath lattice girders in precast elements

Ordering example, Enquiry specification text, Software

Ordering example

JDA-Standard

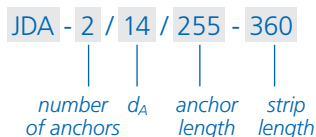

JDA optimized

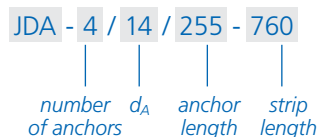

anchor spacing: (lk1/lA1/lA2/lA3/.../lk2)

JDA-FT-KL (for precast)

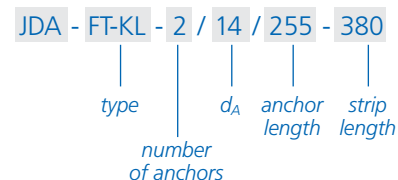

anchor spacing: (lk1/lA1/.../lk2)

Spacers For installing JDA from below you need suitable spacers between strip and formwork. Spacers for **15, 20, 25, and 30 mm** are available.

Enquiry specification text

To provide JORDAHL® punching shear reinforcement JDA to supplement the reinforcement of areas weakened by penetration on flat roofs of thickness $d = \square$ cm with point type supports and to install in accordance with information provided by the support structure designer.

Punching shear reinforcement

Type JDA- \square / \square / \square - \square , \square pieces

Order list from software

The result of the JORDAHL®-software can be printed in form of an ordering schedule.

JORDAHL BEFESTIGUNGSTECHNIK		Project:	Page:	
		Proj. No.:		
JORDAHL® - Punching Reinforcement JDA - Connector Schedule				
Company:		Date: 19.04.2005		
		Printed from: 19.04.2005		
		Designer:		
No.	Position	No. Pos	No. strips	strip
1	1	1	5	JDA-2/20/265-337 (130/130/77)
			5	JDA-2/20/265-309 (77/155/77)
			5	JDA-2/20/265-309 (77/155/77)

Calculation example

On your request we will send example calculations or help with specific customer enquiries.

Software

We provide easy-to-use calculation software for you to select the correct JDA studrail.

- Calculation in accordance with construction authority approval No.7-15.1-214
- compatible with DIN 1045-1 using partial safety factors



© by Deutsche Kahneisen Gesellschaft mbH.

All rights reserved.

We reserve the right to modifications within the framework of continued development concerning the product and application methods.



JORDAHL®

FIXING TECHNOLOGY



HEADQUARTER

GERMANY
Deutsche Kahneisen
Gesellschaft mbH
Nobelstraße 51
D-12057 Berlin
Phone: 0049 30 6 82 83-02
Fax: 0049 30 6 82 83-4 97
Technical
Dept.: 0049 30 6 82 83-4 98
Sales: 0049 30 6 82 83-4 94

Production Plant Trebbin
Industriestraße 5
D-14959 Trebbin
Phone: 0049 33731 88-0
Fax: 0049 33731 88-141

info@jordahl.de
www.jordahl.de

FRANCE

Arteon S.A.
12 rue des Cressonnières
F-95500 Gonesse
Phone: 0033 134 45 90 45
Fax: 0033 139 85 36 25
www.arteon.fr
arteon@arteon.fr

INDIA

M+V Marketing & Sales Pvt. Ltd.
No. 1, Madhavi Apartments,
2102/5 Vijaynagar Colony
Sadashiv Peth, Off Tilak Road
IND-411030 Pune
Phone: 0091 20 24 32 78 72
Fax: 0091 20 24 32 78 73
gurtoo@jordahl.in

NETHERLANDS

Vebo-Staal B.V.
Industrieterrein
Röntgenweg 3
NL-3752 LJ Bunschoten
Phone: 0031 33 29 92 687
Fax: 0031 33 29 92 690
hhoebe@vebo-staal.nl

RUSSIA

OOO Bau MonTek
pos. Vnukovo,
ul. Zentralnaja, 16, str. 6
RUS-119027 Moscow
Phone: 007 495 436 77 12
Fax: 007 495 436 73 30
www.baumontek.ru
info@baumontek.ru

SPAIN-PORTUGAL

J&P Tecnicas de Anclaje s.l.
Avda. de los Pirineos,
no. 25, nave 20
ES-28700 S.S. de los Reyes (Madrid)
Phone: 0034 91 65 93 185
Fax: 0034 91 65 93 139
www.jp-anclajes.com
jp@jp-anclajes.com

SUBSIDIARIES AND AGENTS

AUSTRIA
GHL Bautechnik
Produktions- und Handel GmbH
Caracallastr. 16
A-4470 Enns
Phone: 0043 7223 819 19 0
Fax: 0043 7223 819 19 33
www.ghl-bau.at
office@ghl-bau.at

DENMARK

**Jordahl & Pfeifer
Byggeteknik A/S**
Risgårdevej 66, Risgårde
DK-9640 Farsø
Phone: 0045 98 63 19 00
Fax: 0045 98 63 19 39
www.jordahl-pfeifer.dk
info@jordahl-pfeifer.dk

GREAT BRITAIN

J&P Building Systems Ltd.
Unit 5, Thame 40
Jane Morbey Road
GB-Thame/Oxon OX9 3RR
Phone: 0044 1844 215200
Fax: 0044 1844 263257
www.jandpbuildingsystems.com
enquiries@jandpbuildingsystems.com

ITALY

Frank Italy GmbH
Industriezone, Mühlen 3
I-39032 Sand in Taufers (BZ)
Phone: 0039 0474 65 90 08
Fax: 0039 0474 65 90 18
www.frank-italy.com
info@frank-italy.com

NORWAY

Pretec A/S
Postboks 102
N-1740 Borgenhaugen
Phone: 0047 69 10 24 60
Fax: 0047 69 16 71 41
www.pretec.no
even@pretec.no

SAUDI ARABIA

**Rolaco Trading & Contracting
Building Materials Division**
Al-Sulaiman Bldg.
P.O. Box 222 Medinah Road
SA-21411 Jeddah
Phone: 00966 2 651 80 28
Fax: 00966 2 653 42 80
www.rolaco.net
hrezk@rolaco.net

SWEDEN

Pre Tec Precast Technology AB
Traktorgatan 13
S-44240 Kungälv
Phone: 0046 303 243 080
Fax: 0046 303 913 10
www.pretec.se
info@pretec.se

BELGIUM

N. V. Plakabeton S.A.
Industrielaan 2
B-1740 Ternat
Phone: 0032 2 58 22 94 5
Fax: 0032 2 58 35 16 8
dirk.vanloo@plakabeton.be

ESTONIA

AS Semtu
Suur Sojamäe 33
EE-11415 Tallinn
Phone: 00372 606 38 70
Fax: 00372 606 38 71
semtu@semtu.ee

HONG KONG

Sino Linker Limited
Room 2002, Seaview Commercial Bldg.
21 Connaught Road West, Sheung Wan
HK-Hong Kong
Phone: 00852 22 85 80 38
Fax: 00852 22 85 83 37
gm@sinolinker.com.hk

LATVIA

Semtu SIA
Gailezera 8
LV-1079 Riga
Phone: 00371 738 39 81
Fax: 00371 738 39 81
semtu@parks.lv

POLAND

**J&P Technika Budowlana
Sp. z o.o.**
Ul. Wroclawska 68
PL-55-330 Krepice k/Wroclawia
Phone: 0048 71 39 68 364
Fax: 0048 71 39 68 106
www.j-p.pl
biuro@j-p.pl

SINGAPORE

J&P Building Systems Pte Ltd
No. 48 Toh Guan Road East
#08-104 Enterprise Hub
SG-Singapore 608586
Phone: 0065 65 69 61 31
Fax: 0065 65 69 52 86
www.jnp.com.sg
info@jnp.com.sg

SWITZERLAND

**Ankaba Ankerstechnik und
Bauhandel AG**
Zürichstraße 38a
CH-8306 Brüttisellen
Phone: 0041 44 807 17 17
Fax: 0041 44 807 17 18
www.ankaba.ch
info@ankaba.ch

CZECH REPUBLIC

J&P Stavebni Technika s.r.o.
Prumyslova 5
CZ-10850 Praha 10
Phone: 00420 2 72 70 07 01
Fax: 00420 2 72 70 37 37
www.jp.cz
Info@jp.cz

FINLAND

Semtu Oy
P.O. Box 124
FIN-04201 Kerava
Phone: 00358 927 47 95 0
Fax: 00358 927 47 95 40
www.semtu.com
mailbox@semtu.fi

HUNGARY

Pfeifer-Garant KFT
Gyömrői u. 128
H-1103 Budapest
Phone: 0036 1 260 10 14
Fax: 0036 1 262 09 27
www.pfeifer-garant.hu
pfeifer.garant@axelero.hu

LITHUANIA

UAB Semtu
S. Neries str. 21
LU-06313 Vilnius
Phone: 00370 52 31 15 48
Fax: 00370 52 31 16 53
techkonsultantas@semtu.lt

ROMANIA

**S.C. JORDAHL & PFEIFER
Tehnica de Ancorare S.R.L.**
str. Malului nr. 7 et.1
RO-550197 Sibiu, jud. Sibiu
Phone: 0040 269 24 60 98
Fax: 0040 269 24 60 99
www.jordahl-pfeifer.ro
info@jordahl-pfeifer.ro

SLOVAKIA

J&P Stavebni Technika s.r.o.
Prumyslova 5
CZ-10850 Praha 10
Phone: 00420 2 72 70 07 01
Fax: 00420 2 72 70 37 37
www.jp.cz
info@jp.cz

U. A. E.

**EMIRATES GERMAN BUILDING
Materials Trading L.L.C.**
P.O. Box 18917
Store No: ST-1
Al-Qusais Ind. Area-4 Beirut Street
U. A. E. -Dubai
Phone: 00971 4 267 66 44
Fax: 00971 4 267 66 46
gemirate@emirates.net.ae