

Removing the foam filler the anchor channel after striking the foam work

After striking the foam work remove the fixing of concrete sedimentation.
After wards remove the foam filler.

Fig. 1 Polystyrene bead filler

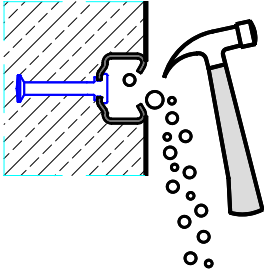

Use an appropriate tool (c.g. carpenters, hammer, hook with flat tip or similar).

Fig. 2 Combination strip filler

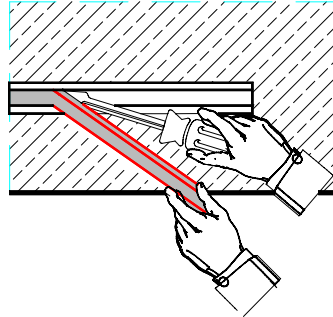

Catch the strip on one end by hand and pull it out with the aid of a tool, e.g. a scew driver.

Fixing the JORDAHL - bolt to the JORDAHL - anchor channel

Fig. 3

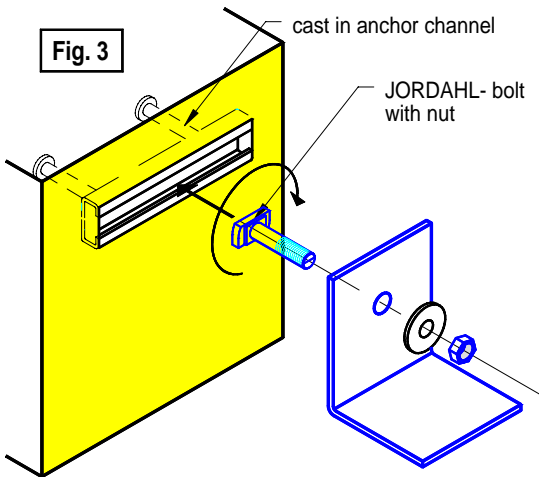

Fig. 3:

The JORDAHL - bolt can be inserted into the channel slot at any point along the channel length. After a 90° turn clockwise, the head of the bolt locks into position to enable the nut to be tightened.

JORDAHL - bolts must not be mounted closer than 25 mm from the end of a channel.

After fixing: check the correct fit of the JORDAHL - bolt. The groove on the shank end of the bolt must be perpendicular to the channel longitudinal axis.

Fig. 4

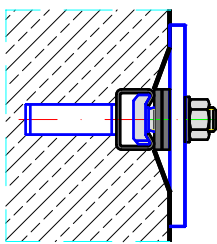

Fig. 4:

If the face of the channel is recessed from the concrete surface, then shims must be used between the face of the channel and the back of the component in order to create a flush surface. Note: The admissible bending moment of the JORDAHL - bolt may not be exceeded.

Fig. 5

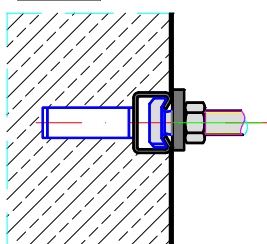

Fig. 5:

Washers should always be used under the nut. For space mounting use the special washers. The admissible bending moment of the JORDAHL - bolt may not be exceeded.

Fig. 6

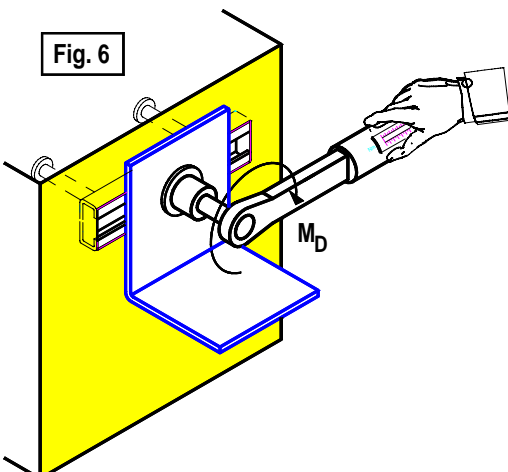

Fig. 6:

Tighten the nuts to the recommended torque according to the table.

bolt-type	Strength/ material grade	Recommended torques [Nm]								
		M 6	M 8	M 10	M 12	M 16	M 20	M 24	M 27	M 30
JA, JB JC, JE JD/JUD JH/JUH	4,6 A4-50/70 FA-70	3	8	15	25	60	120	200	300	400
	8,8			48	70	200	400	680	1000	1400
JXD JXH	8,8 FA-70			40	80	120				
JZS	8,8 A4-50				50	90				